

CROMA

16 years of best-selling excellence, proven by craftsmanship and quality



CROMA



 **HEXAGON**

Croma Touch Probe Heads and Accuracy

- **HH-A-M7.5**



HH-A-M 7.5 Automatic Probe Heads

The HH-A-M7.5 can automatically rotate in both vertical and horizontal directions. With 7.5° indexing, it enables 720 probe angle combinations. A 90° rotation takes only two seconds. It supports extension rods up to 300 mm and is compatible with various touch-trigger probes.

Positioning Repeatability	0.5µm
Indexing Angle	7.5°
Total Measuring Positions	720
Indexing Range	A = 0° to 105° B = ±180°
Rotation Speed	90°/2 seconds
Maximum Extension Rod Length	300mm

- **HP-TMe**

- **TP200**



HP-TMe / TP200 Touch-Trigger Probes

Probe Configuration for Performance Testing:

HP-TMe / TP200: Standard measuring force; probe length: 10 mm; stylus tip diameter: 4 mm.

HP-TMe: Maximum stylus length: 60 mm; service life exceeds 2 million probing cycles.

TP200: Maximum stylus length: 100 mm; service life reaches up to 10 million cycles; offers higher accuracy.

Performance specifications are valid under the following environmental conditions:

Ambient temperature: 18°C to 22°C

Maximum temperature variation: 1°C per hour or 2°C per 24 hours

Maximum temperature gradient: 1°C per meter

	HP-TMe			TP200			Dynamics	
Model	E0 /E150	PFTU	RO	E0 /E150	PFT	RO	3D Max (.Speed)	3D Max (.Acc)
05. 06. 04	2.3+ L/300	2.5	2.3	2.1+ L/300	2.3	2.1	520	1730
06. 08. 06	2.3+ L/300	2.5	2.3	2.1+ L/300	2.3	2.1	520	1730
08. xx. 06	2.4+ L/300	2.6	2.4	2.2+ L/300	2.4	2.2	520	1470
10. xx. 08	2.6+ L/300	2.8	2.6	2.4+ L/300	2.6	2.4	520	1470
12. xx. 10	2.9+ L/300	3.4	2.9	2.7+ L/300	2.9	2.7	433	1040
15. xx. 10	3.4+ L/300	3.9	3.4	3.2+ L/300	3.4	3.2	433	1040
15. xx. 12	3.9+ L/300	4.4	3.9	3.7+ L/300	3.9	3.7	433	1040
18. xx. 10	4.4+ L/300	4.9	4.4	4.2+ L/300	4.4	4.2	433	1040
18. xx. 12	4.9+ L/300	5.4	4.9	4.7+ L/300	4.9	4.7	433	1040
18. xx. 15	5.4+ L/300	5.9	5.4	5.2+ L/300	5.4	5.2	433	1040
20. 33. 10	5.5+ 6L/1000	6.0	5.5	5.3+ 6L/1000	5.5	5.3	346	693

Croma Scan Probe Heads and Accuracy

• HH-A-T7.5

• HH-AS8-T7.5

HH-A-T7.5 Automatic Probe Heads



The HH-A-T7.5 can automatically rotate in both vertical and horizontal directions. Its 7.5° indexing enables 720 probe angle combinations. A 90° rotation takes only two seconds. It supports extension rods up to 300 mm and can connect to various types of probes, including touch-trigger probes, analog scanning probes, and non-contact probes.

Positioning Repeatability	0.5µm
Indexing Angle	7.5°
Total Measuring Positions	720
Indexing Range	A = 0° to 105° B = ±180°
Rotation Speed	90°/2 seconds
Maximum Extension Rod Length	300mm

Croma Scan Probe Heads and Accuracy

• HP-S-X1S/H

• HP-S-X1C

HP-S-X1S/H, H-S-X1C Scanning Probes



Probe Configuration for Performance Testing:

HP-S-X1: Probe length: 50 mm; stylus tip diameter: 5 mm.

HP-S-X1S: Maximum stylus length — Vertical: 115 mm, Horizontal: 20 mm.

HP-S-X1H / X1C: Maximum stylus length — Vertical: 225 mm, Horizontal: 100 mm.

Performance specifications are valid under the following environmental conditions:

Ambient temperature: 18°C to 22°C

Maximum temperature variation: 1°C per hour or 2°C per 24 hours

Maximum temperature gradient: 1°C per meter

HP-S-X1					Dynamics	
Model	E0 /E150	PFTU	THP/t	RO	3D Max (Speed)	3D Max (Acc)
05. 06. 04	1.9+ L/300	1.9	3.0/58	1.9	520	1730
06. 08. 06	1.9+ L/300	1.9	3.0/58	1.9	520	1730
08. xx. 06	2.0+ L/300	2.0	3.5/58	2.0	520	1470
10. xx. 08	2.3+ L/300	2.3	4.0/58	2.3	520	1470
12. xx. 10	2.6+ L/300	2.6	5.0/58	2.6	433	1040
15. xx. 10	3.1+ L/300	3.1	5.2/68	3.1	433	1040
15. xx. 12	3.6+ L/300	3.6	5.2/68	3.6	433	1040
18. xx. 10	4.1+ L/300	4.1	5.5/68	4.1	433	1040
18. xx. 12	4.6+ L/300	4.6	6.0/68	4.6	433	1040
18. xx. 15	5.1+ L/300	5.1	6.0/68	5.1	433	1040
20. 33. 10	5.2+ 6L/1000	5.2	6.2/68	5.2	346	693

Multiple measuring ranges available

Croma

Model	Stroke (mm)			Dimension (mm)					Range (mm)		
	X	Y	Z	Lx	Lx1*	Ly	Lz	Lz1**	Dx	Dz	Dz1
05.06.04	500	600	400	1055	1020	1535	2247	1747	634	114	594
06.08.06	600	800	600	1150	1107	1735	2630	1947	734	114	794
08.10.06	800	1000	600	1350	1320	1935	2640	1967	934	114	794
08.15.06	800	1500	600	1350	1320	2435	2640	1967	934	114	794
10.12.08	1000	1200	800	1615		2220	2955		1130	118	940
10.15.08	1000	1500	800	1615		2520	2955		1130	118	940
10.21.08	1000	2100	800	1615		3120	2965		1130	118	940
10.30.08	1000	3000	800	1615		4020	3025		1130	118	940
12.15.10	1200	1500	1000	1840	1740	2895	3360	2260	1339		1173
12.22.10	1200	2200	1000	1840	1740	3595	3410	2315	1339		1173
12.30.10	1200	3000	1000	1840	1740	4395	3440	2345	1339		1173
15.22.10	1500	2200	1000	2140	2040	3595	3410	2315	1639		1173
15.30.10	1500	3000	1000	2140	2040	4395	3440	2345	1639		1173
15.22.12	1500	2200	1200	2140	2040	3595	3810	2515	1639		1373
15.30.12	1500	3000	1200	2140	2040	4395	3840	2545	1639		1373
18.22.10	1800	2200	1000	2440	2340	3595	3410	2315	1939		1173
18.30.10	1800	3000	1000	2440	2340	4395	3440	2345	1939		1173
18.22.12	1800	2200	1200	2440	2340	3595	3810	2515	1939		1373
18.30.12	1800	3000	1200	2440	2340	4395	3840	2545	1939		1373
18.22.15	1800	2200	1500	2440	2340	3595	4410	2815	1939		1673
18.30.15	1800	3000	1500	2400	2340	4395	4440	2845	1939		1673
20.33.10	2000	3300	1000	2690	2590	4695	3460	2365	2189		1173
20.33.12	2000	3300	1200	2690	2590	4695	3860	2565	2189		1373
20.33.15	2000	3300	1500	2690	2590	4695	4460	2865	2189		1673

*Minimum door width

** Minimum door height

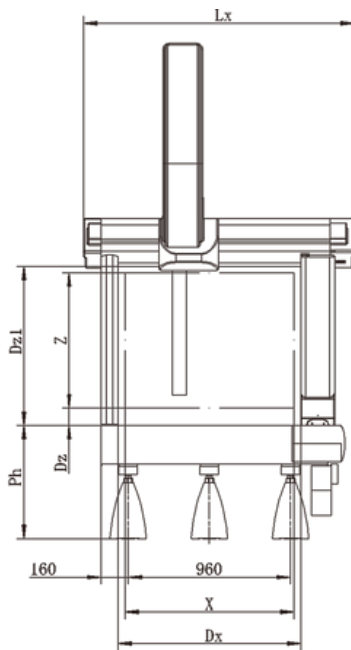
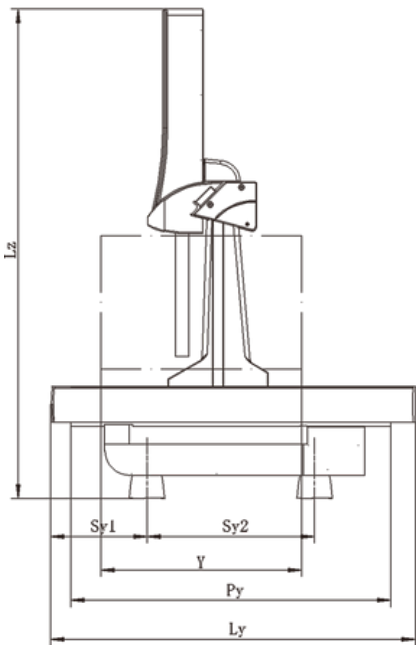
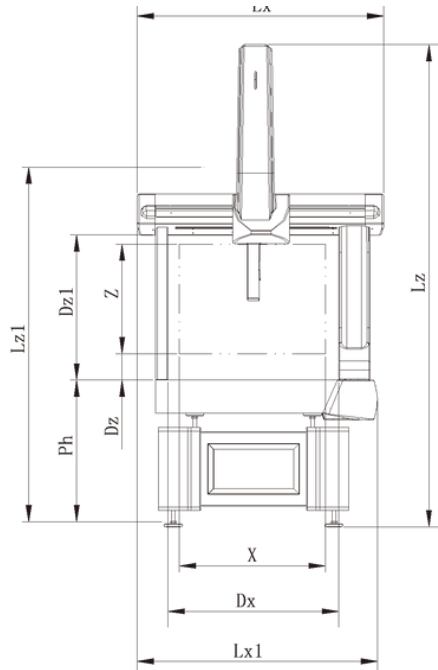
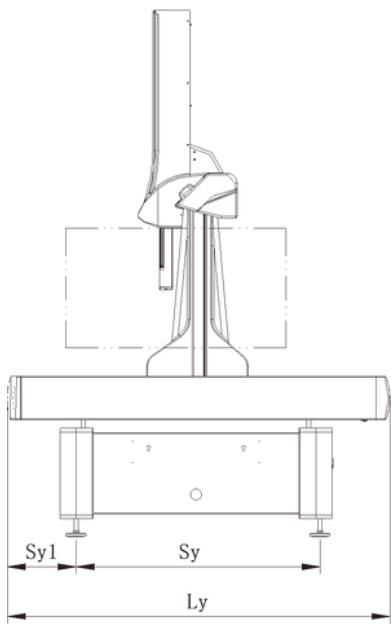
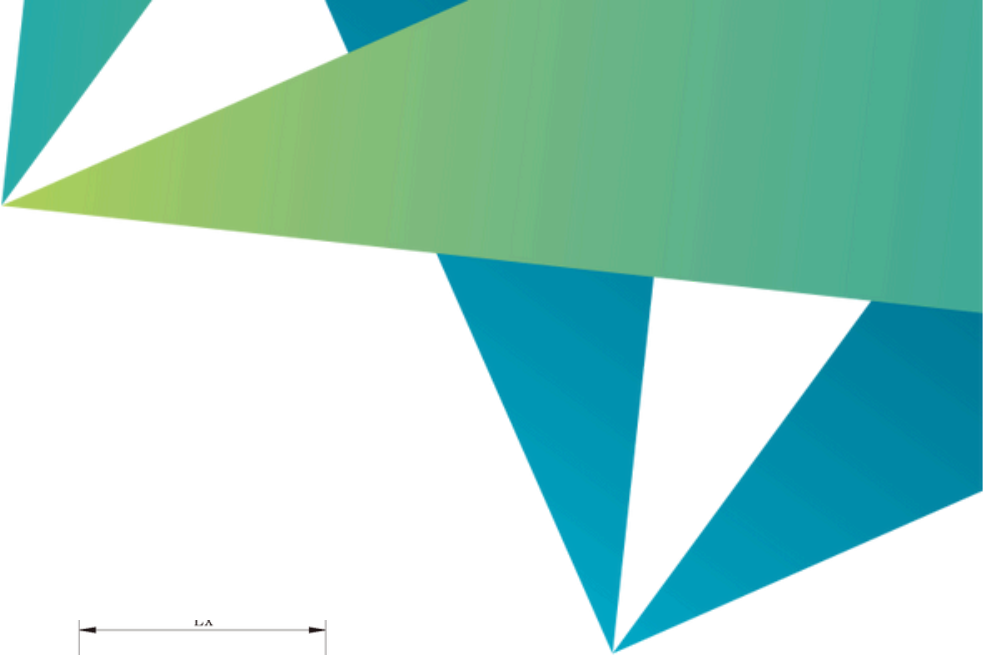

Technical Specifications

 <h3>Guide Rail</h3> <p>X and Y: Extruded lightweight aluminum alloy with ultra-precision machining and anodizing treatment Y: Integrated dovetail guide rail directly machined into the worktable</p>	 <h3>Measurement Platform (Worktable)</h3> <p>Material: Granite Workpiece fixation: M8 x 1.25 threaded inserts</p>	 <h3>Measurement System</h3> <p>Counting system: High-resolution gold optical grating scale Touch probe resolution: 0.078µm Scan probe resolution: 0.005µm</p>
 <h3>Environment</h3> <p>Operating temperature range: 10 -40°C Relative humidity: 90%, no condensation</p>	 <h3>Temperature Compensation System</h3> <p>Croma12 / 15 / 18 / 20 standard, others optional</p>	 <h3>Air Supply</h3> <p>Minimum supply air pressure: 5bar Air consumption: 180NL/min</p>
 <h3>Air Bearings</h3> <p>Pre-loaded air bearings used for each axis</p>	 <h3>Z-Axis Balance</h3> <p>Flexible balancing system, adjustable</p>	 <h3>Power Supply</h3> <p>Voltage: 220V/50Hz</p>

Contact us

SINGAPORE

Hexagon Metrology Asia Pacific Pte Ltd 151 Lorong Chuan, #05-09 (Lobby H), New Tech Park, Singapore 556741
T: +65 6463 6242
F: +65 6463 8030
E: contact.sg.mi@hexagon.com

MALAYSIA

Hexagon Measurements Technologies Sdn. Bhd. No. 26, Jalan Serendah 26/41, Sekitar 26, Seksyen 26, 40400 Shah Alam, Selangor Darul Ehsan, Malaysia
T: +603 5103 0640
F: +603 5103 9126
E: contact.my.mi@hexagon.com

THAILAND

Hexagon Metrology (Thailand) Ltd. 3 Soi Bangna-Trad 34, Debaratna Road., Bangna Tai, Bangna, Bangkok 10260, Thailand
T: +66 2 361 3695 to 9
F: +66 2 746 9607
E: contact.th.mi@hexagon.com

INDONESIA

Hexagon Metrology Asia Pacific Pte Ltd Ruko Icon City No. C19, Jl. Raya Boulevard Delta Mas No. 189, Desa/Kelurahan Sukamahi, Kec. Cikarang Pusat, Kab. Bekasi, Provinsi Jawa Barat, 17531, Indonesia
T: +62 21 89118886
E: IDJAKAftermarket.mi@hexagon.com

VIETNAM

Hanoi Office
Villa B5-16, Vinhomes Gardenia, Cau Dien Ward, Nam Tu Liem District, Hanoi, Vietnam
T: +84 24 3253 5666 F: +84 24 3253 5255
E: contact.vn-hn.mi@hexagon.com



CROMA



SCAN



Hexagon is a global leader in sensor, software and autonomous solutions. We are putting data to work to boost efficiency, productivity, and quality across industrial, manufacturing, infrastructure, safety, and mobility applications.

Our technologies are shaping urban and production ecosystems to become increasingly connected and autonomous – ensuring a scalable, sustainable future.

Hexagon's Manufacturing Intelligence division provides solutions that utilize data from design and engineering, production and metrology to make manufacturing smarter. For more information, visit hexagonmi.com.

Learn more about Hexagon (Nasdaq Stockholm: HEXA B) at hexagon.com and follow us [@HexagonAB](https://twitter.com/HexagonAB).